

TRAD 1

FARETTO FISSO con 16 LED da 0,1 W

Struttura in acciaio inox con diffusore rotondo in acrilico.

Alimentazione: 220-240 VAC / 50-60 Hz.

Consumo: 1,6 W.

Alimentatore incorporato.

Installazione

Tramite viti.

SPOTLIGHT with 16 LEDs 0.1 W

Structure in stainless steel with acrylic diffuser round light.

Supply current: 220-240 VAC / 50-60 Hz.

Consumption: 1.6 W.

Led power supply integrated.

Installation

By screws.

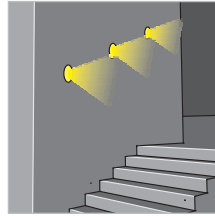
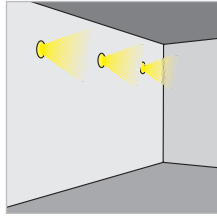

Abbinabile a luci di emergenza.
Matchable with emergency lights.



FINITURA / FINISHING
↓
COLORE LED / LED COLOUR
↓
FOCALE / BEAM SPREAD
↓
484-01- **AO** **10** **00**
CODICE / CODE



CE IP20

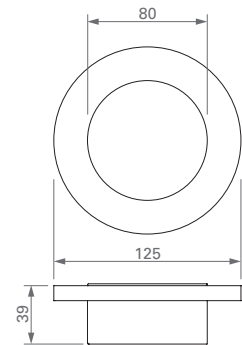

DIMENSIONI / DIMENSIONS

ABID 1

FARETTO FISSO con 16 LED da 0,1 W

Struttura in acciaio inox con diffusore quadrato in acrilico.

Alimentazione: 220-240 VAC / 50-60 Hz.

Consumo: 1,6 W.

Alimentatore incorporato.

Installazione

Tramite viti.

SPOTLIGHT with 16 LEDs 0.1 W

Structure in stainless steel with acrylic diffuser square light.

Supply current: 220-240 VAC / 50-60 Hz.

Consumption: 1.6 W.

Led power supply integrated.

Installation

By screws.

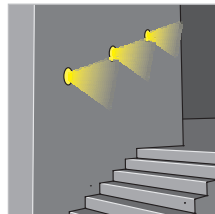
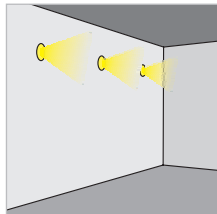

Abbinabile a luci di emergenza.
Matchable with emergency lights.



FINITURA / FINISHING
↓
COLORE LED / LED COLOUR
↓
FOCALE / BEAM SPREAD
↓
485-01- **AO** **10** **00**
CODICE / CODE



CE IP20

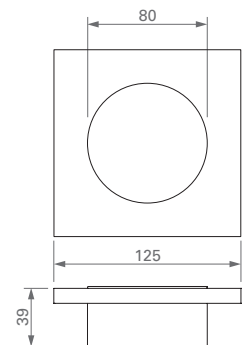

DIMENSIONI / DIMENSIONS